

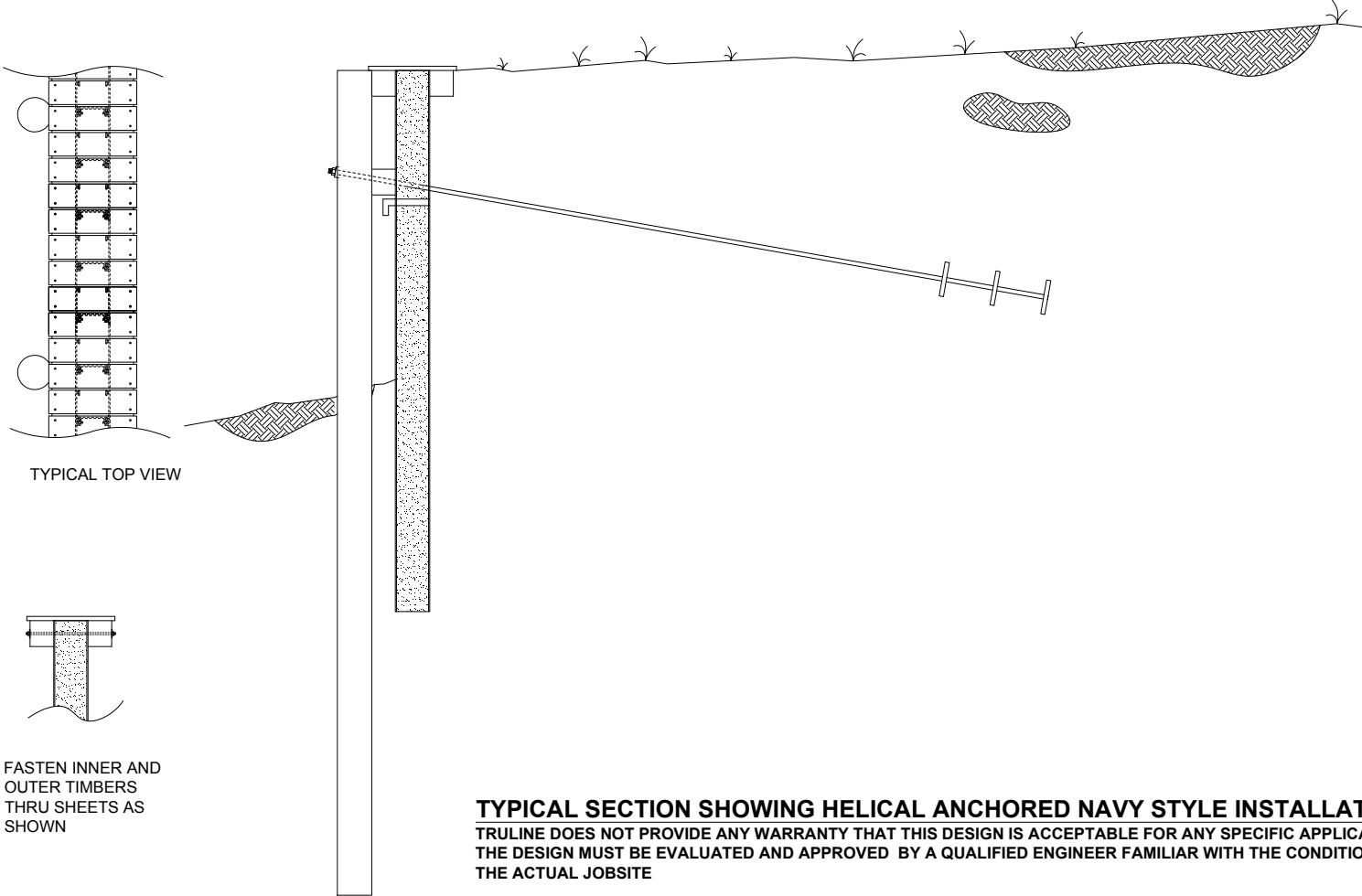

DRAWING P: helical anchored navy style installation

WOODEN PILING DRIVEN IN FRONT OF WALL. SIZE, SPACING AND DEPTH OF EMBEDMENT DETERMINED TO SUPPORT WALL IN A CANTILEVERED MANNER. ADDITIONAL MID WALES CAN BE ADDED AS NEEDED.



WOODEN TOP CAP
CONSTRUCTED
FROM PRESSURE
TREATED TIMBERS
AND COMPOSITE
DECK BOARDS

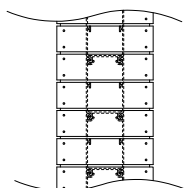

TYPICAL TOP VIEW

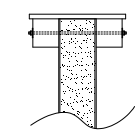

FASTEN INNER AND
OUTER TIMBERS
THRU SHEETS AS
SHOWN

FASTEN DECK
BOARDS TO
TIMBERS WITH
STAINLESS
FASTENERS TO
PROVIDE FOR
LONG TERM
COMPOSITE
ACTION OF
ASSEMBLED CAP

TYPICAL SECTION SHOWING HELICAL ANCHORED NAVY STYLE INSTALLATION

TRULINE DOES NOT PROVIDE ANY WARRANTY THAT THIS DESIGN IS ACCEPTABLE FOR ANY SPECIFIC APPLICATIONS. THE DESIGN MUST BE EVALUATED AND APPROVED BY A QUALIFIED ENGINEER FAMILIAR WITH THE CONDITIONS ON THE ACTUAL JOBSITE